

REV	EC No.	DESCRIPTION	Symbol	DATE
A	/	new release	/	Sep 22, 2017
A1	/	Add pictures	/	Jan 12, 2021



TOP VIEW



BOTTOM VIEW

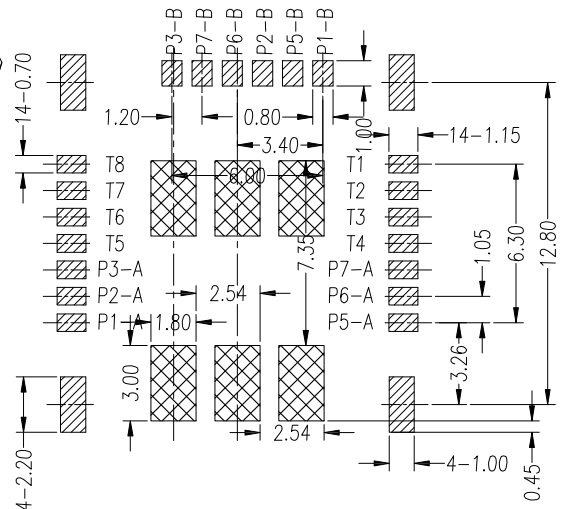
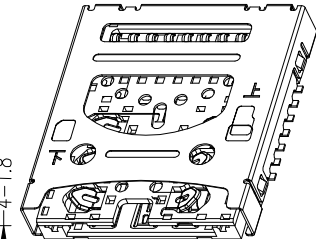

RECOMMENDED PCB LAYOUT

TOL.: ± 0.05  
 SMT SOLDER AREA  
 NO PATTERN AND VIA HOLE IN HTIS AREA

No.	Part name	Material	FINISH
4	Tray	Sus301 T=0.12	None
3	Shell	Sus301 T=0.12	50u"Min. Ni underplated all;1~3u"Min.Au plated solder Legs
2	Contact	C5210 T=0.10	50u"Min. Ni underplated all;1~3u"Min.Au plated Contact Area&Solder tail
1	Housing	LCP S475;Black	UL 94V-0

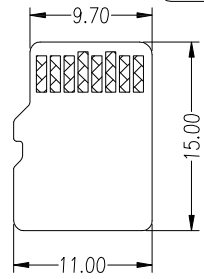
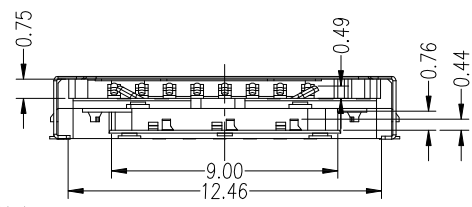
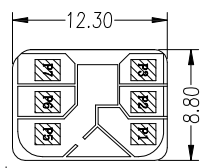
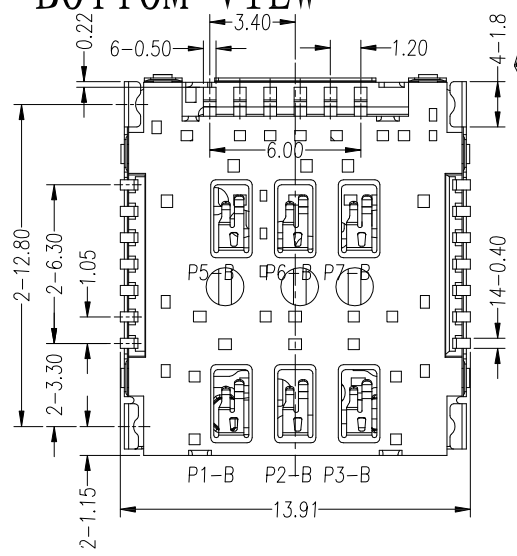
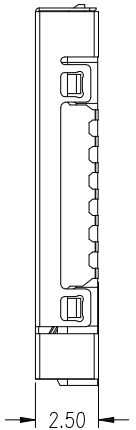
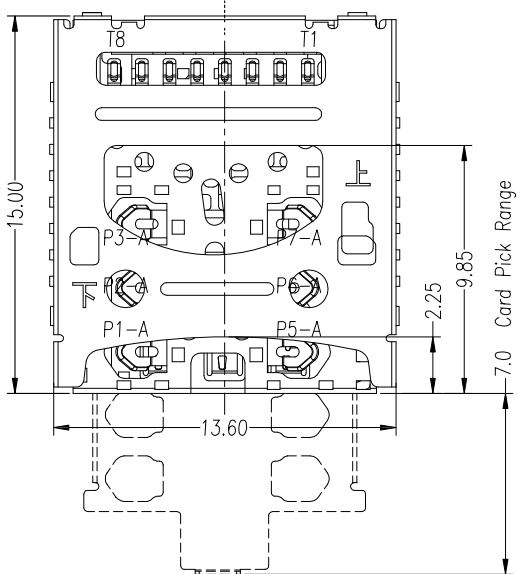

Note:  
 1.Specification:  
 1.1 Voltage Rating:50V  
 1.2 Current rating: 1 A Max.  
 1.3 Dielectric withstanding voltage: 250 V(ac) for 1 min  
 1.4 Contact resistance: 50 mΩ Max.  
 1.5 Insulation resistance: 1000 MΩ Min.  
 1.6 Durability: 3000 Cycles  
 1.7 Temperature range: -30°C~80°C

NANO SIM PIN DEFINE

No.	PIN DEFINE
P1	Vcc
P2	RST
P3	CLK
--	Reserved
P5	GND
P6	Vpp
P7	I/O
--	Reserved

microSD PIN DEFINE

No.	PIN DEFINE
T1	DAT2
T2	CD/DAT3
T3	CMD
T4	VDD
T5	CLK
T6	Vss
T7	DAT0
T8	DAT1

For more information, please help to contact: [connmold@foxmail.com](mailto:connmold@foxmail.com), Tel.:18922965797

WWW.CONNMOLD.COM

DIMENSION UNITS	TOLERANCE	<b>ConnMold</b>	PART NAME <b>2in1 2.50MM HEIGHT TYPE</b>
<b>MM</b>	X±0.50 .XX±0.25 .X±0.35 .XXX±0.15		
DRWN:Robert	Jan.12,2021	PART NUMBER <b>CMNSM661006</b>	
CHK'D:Yuri	Jan.12,2021	REVISION <b>A1</b>	
APPR:Linda	Jan.12,2021	CUSTOMER <b>GENERAL MARKET</b>	SHEET NUMBER <b>1 OF 2</b>

THIRD ANGLE PROJECTION

CUSTOMER P/N **/**