

6

5

4

3

2

1



REV	EC No.	DESCRIPTION	Symbol	DATE
A	/	new release	/	Oct. 10, 2019

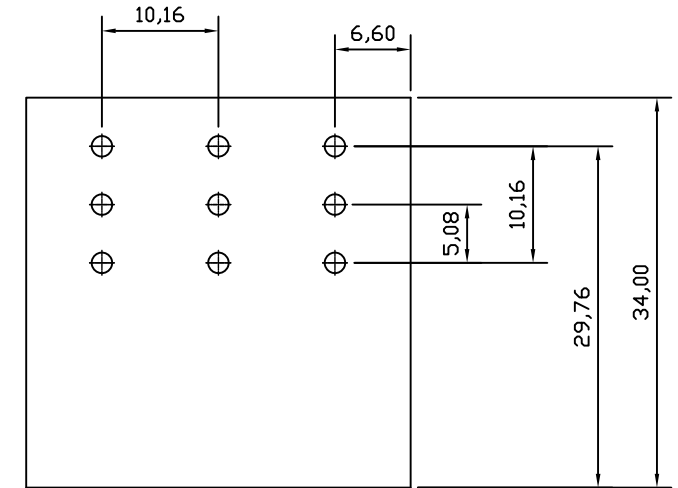
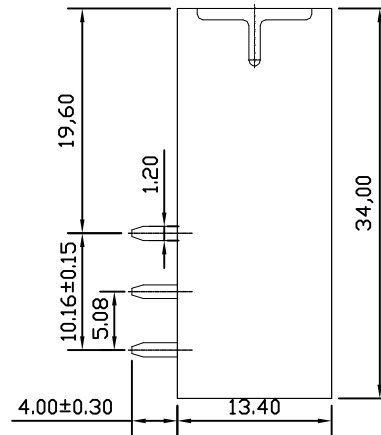
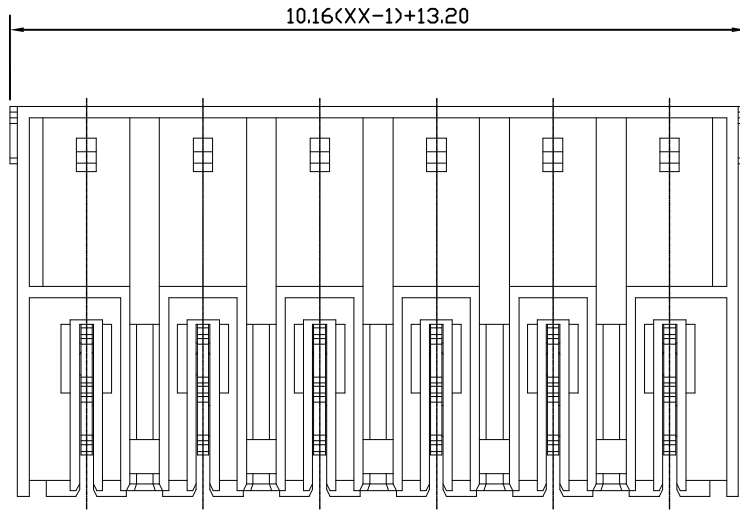

RECOMMENDED PCB LAYOUT  
TOLERANCE UNSPECIFIED ±0.05mm

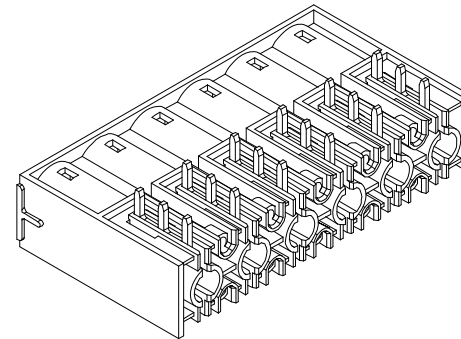
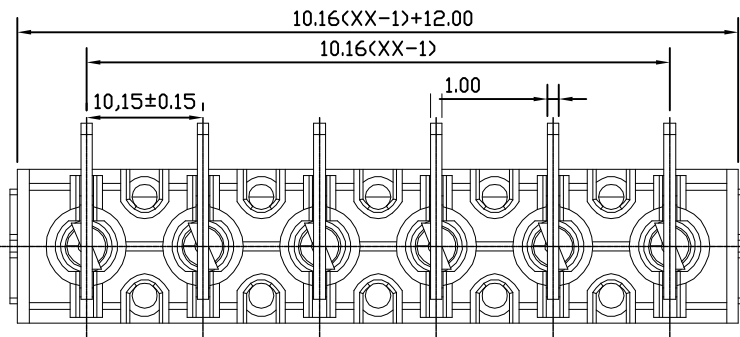

CMPHM<sub>xx</sub>1001

— 02: 2PIN  
— 03: 3PIN  
— 18: 18PIN

Other data	
Pitch	10.16
Poles	02~18
Stripping length	—
Screw torque	—
Operating temperature	-40~105
Soldering temperature	260°C/5S
Pin dimension	1.0*1.20
PCB hole	φ1.80

Material	
Insulator	PA66
Flammability	UL 94V-0
Contactior	Copper
Coating	Sn

IEC TECHNICAL DATA			
Overvoltage category	III	III	II
Contamination class	3	2	2
Rated voltage	1000	1000	1000
Rated current	76	76	76
Impulse withstand voltage:(KV)	8.0	8.0	8.0
conductor cross section Solid(mm <sup>2</sup> )			

Technical Data			
Use Group	B	C	D
Rated voltage	300	300	300
Rated current	55	55	10
Wire range solid (AWG)			
Withstanding Voltage	1600V/1min		

linear dimension (tolerance standard)										
Variable Range	0 to 6	6 to 10	10 to 30	30 to 60	60 to 100	100 to 160	160 to 1000	0 to 10	10 to 100	100 to 1000
tolerance	±0.20	±0.30	±0.50	±0.70	±1.00	±1.30	±1.60	0.10	0.30	0.60

For more information, please help to contact: connmold@foxmail.com Tel.:18922965797

WWW.CONNMOLD.COM		ConnMold	
DIMENSION UNITS	TOLERANCE	PART NAME	
MM	X±0.50 .XX±0.25 .X±0.35 .XXX±0.15	PCB HEADER 10.16 PITCH 13.40MM HEIGHT	
DRWN:Robert	Oct. 10, 2019	PART NUMBER	
CHK'D:Yuri	Oct. 10, 2019	CMPHM <sub>xx</sub> 1001	
APPR:Linda	Oct. 10, 2019	REVISION	
THIRD ANGLE PROJECTION		CUSTOMER	
		GENERAL MARKET	
CUSTOMER P/N		SHEET NUMBER	
/		1 OF 1	

6

5

4

3

2

1