

REV	EC No.	DESCRIPTION	Symbol	DATE
A	/	new release	/	Mar. 12, 2018

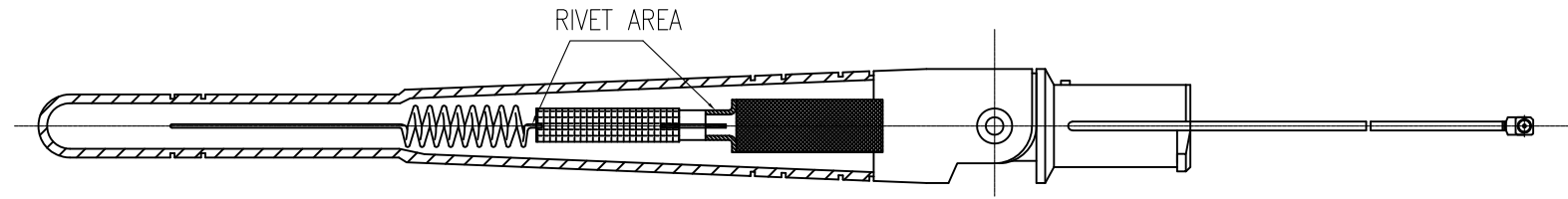
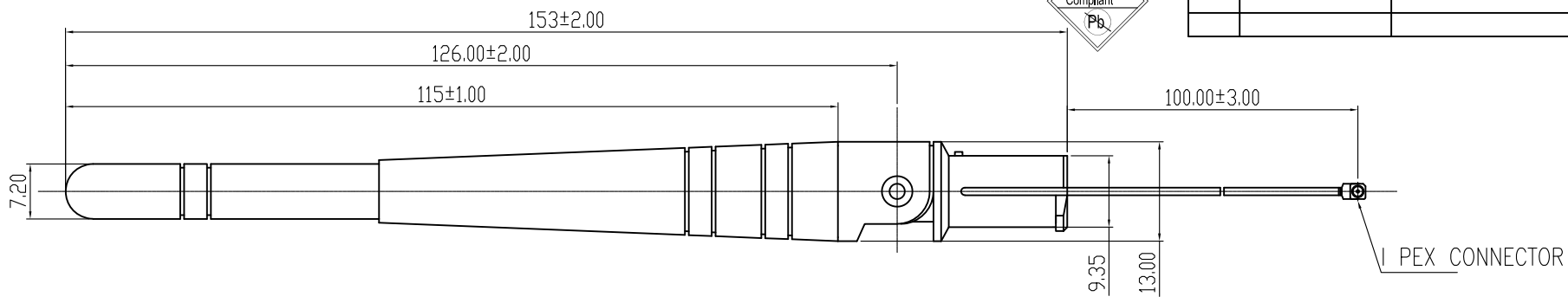
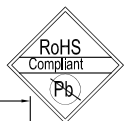

NOTES :

- 1.0. SPECIFICATIONS :
- 1.1. CONNECTOR: IPEX PLUG
 - 1.2. NOMINAL CHARACTERISTIC IMPEDANCE: 50 Ohm
 - 1.3. APPLICABLE FREQUENCY RANGE: 2.4~2.5GHZ
 - 1.4. VSWR: 2.0 MAX.
 - 1.5. TEMPERATURE :-40°C TO +85°C
 - 1.6. RADIATION PATTERN: OMNI-DIRECTIONAL
 - 1.7. ANTENNA HEIGHT:153MM
 - 1.8. ANTENNA GAIN: 3.0 dBi min
 - 1.9. POLARIZATION: VERTICAL

- 2.0. MATERIAL :
- 2.1.CABLE: OD 1.13 BLACK , L=168MM
 - 2.2.OUTER TUBE:ZINC ALLOY $\phi 6.80 \times \phi 1.10 \times L23.00$ MM,
 - 2.3.INNER BOSS : ZINC ALLOY $\phi 4.50 \times L18.50$ MM,
 - 2.4.SPRING: COPPER ALLOY, $\phi 4.30 \times \phi 0.80 \times L59.00$ MM,
 - 2.5.HEAT SHRINKABLE TUBE: $\phi 6.00 \times L25.00$ MM,
 - 2.6.TOP BASE:PC+ABS, BLACK,
 - 2.7.BOTTOM BASE:PC, BLACK,
 - 2.8.LOOP BAR :ABS, BLACK, $\phi 13.00 \times \phi 7.10 \times L115$ MM
 - 2.9.RIVET HEAD :POM , BLACK
 - 2.10.I-PEX PLUG: 1.13 I-PEX 1.50U" GOLD PLATED
 - 2.11.SPONGE :BLACK, $\phi 5.5 \times H4.50$ MM
 - 2.12.SILICON GLUE :WHITE, 704 SILICON GLUE
- 3.0. PACKAGE : PE BAG, BLISTER BOX,CARTON
50PCS/BUCKLE, 1000PCS/CARTON

2.4G

For more information, please feel free to contact Neal. His email is :connmold@foxmail.com Tel:18922965797			
WWW.connmold.COM		<h1>ConnMold</h1>	
DIMENSION UNITS	TOLERANCE		
MM	X±0.50 .XX±0.25	PART NAME 2.4G DIPOLE ANTENNA	
	.X±0.35 .XXX±0.15	3dBi BLACK TYPE L=100MM	
DRWN:Robert	Mar. 12, 2018	PART NUMBER	REVISION
CHK'D:Yuri	Mar. 12, 2018	CMRFA661007	A
APPR:Lee	Mar. 12, 2018	CUSTOMER	SHEET NUMBER
THIRD ANGLE PROJECTION	CUSTOMER P/N	GENERAL MARKET	1 OF 1
	/		