

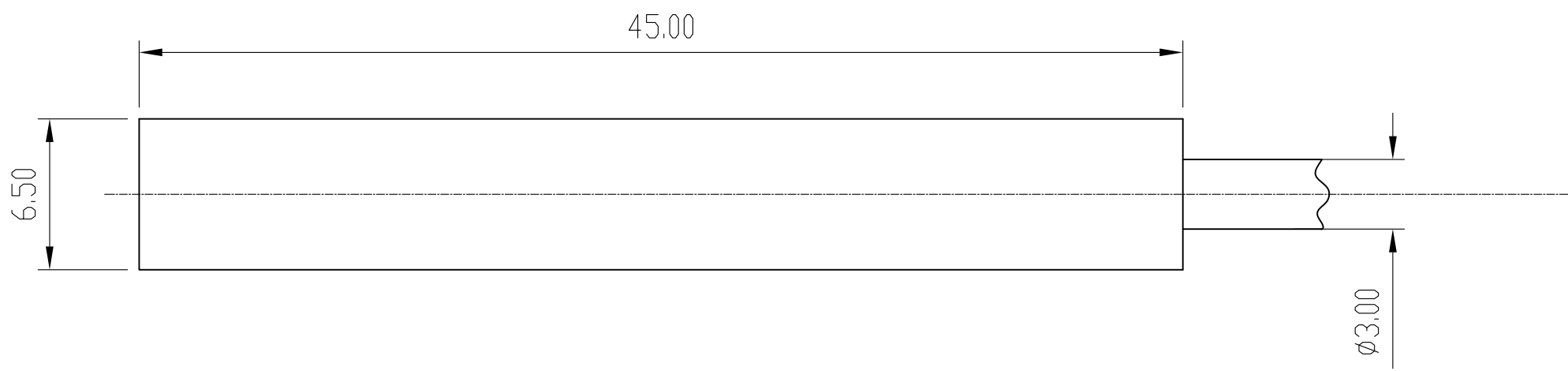

| REV | EC No. | DESCRIPTION | Symbol | DATE |
|-----|--------|-------------|--------|---------------|
| A | / | new release | / | Mar. 12, 2018 |
| | | | | |
| | | | | |



NOTES :

- 1.0. Spec.Ø6.50mm
- 2.0. Metal cover housing: YES, Totally
- 3.0. Sensor distance: 1.50mm
- 4.0. Shell Material:Stainless steel
- 5.0. Operation Voltage:10~30V DC
- 6.0. Pulse Voltage: 10% max
- 7.0. Unload Current: 10mA max
- 8.0. Load Current: 200mA
- 9.0. Leakage current:0.01mA max
- 10.0 Voltage drop: 2.0V max
- 11.0 Frequency: 2K HZ
- 12.0 Response Time:0.1ms / 0.1ms
- 13.0 Power On/Off delay: 15% (Sr) max
- 14.0 Repeat accuracy: 1.0 (Sr) max
- 15.0 Waterproof grade: IP67
- 16.0 Temperature Range: -25°C~+70°C
- 17.0 Temperature change: 10% (Sr) Max
- 18.0 Short protection: YES
- 19.0 Overload current: 220mA
- 20.0 Contact surface material:POM

CMSNS6X1003

- 1: DC3 CABLE 10~30V NPN NORMAL OPEN
- 2: DC3 CABLE 10~30V NPN NORMAL CLOSE
- 3: DC3 CABLE 10~30V PNP NORMAL OPEN
- 4: DC3 CABLE 10~30V PNP NORMAL CLOSE

| | | | |
|--|-------------------|---|--|
| For more information, please feel free to contact Neal. His email is :connmold@foxmail.com Tel:18922965797 | | | |
| WWW.connmold.COM | | <h1>ConnMold</h1> | |
| DIMENSION UNITS | TOLERANCE | | |
| MM | X±0.50 .XX±0.25 | PART NAME Ø6.50mm INDUCTANCE SENSOR DC SMALL SENSOR 1.50mm | |
| | .X±0.35 .XXX±0.15 | | |
| DRWN:Robert Mar. 12, 2018 | | PART NUMBER CMSNS6X1003 | |
| CHK'D:Yuri Mar. 12, 2018 | | REVISION A | |
| APPR:Lee Mar. 12, 2018 | | SHEET NUMBER 1 OF 1 | |
| THIRD ANGLE PROJECTION | CUSTOMER P/N | CUSTOMER | |
| | / | GENERAL MARKET | |