

6

5

4

3

2

1



REV	EC No.	DESCRIPTION	Symbol	DATE
A	/	new release	/	Mar. 12, 2018

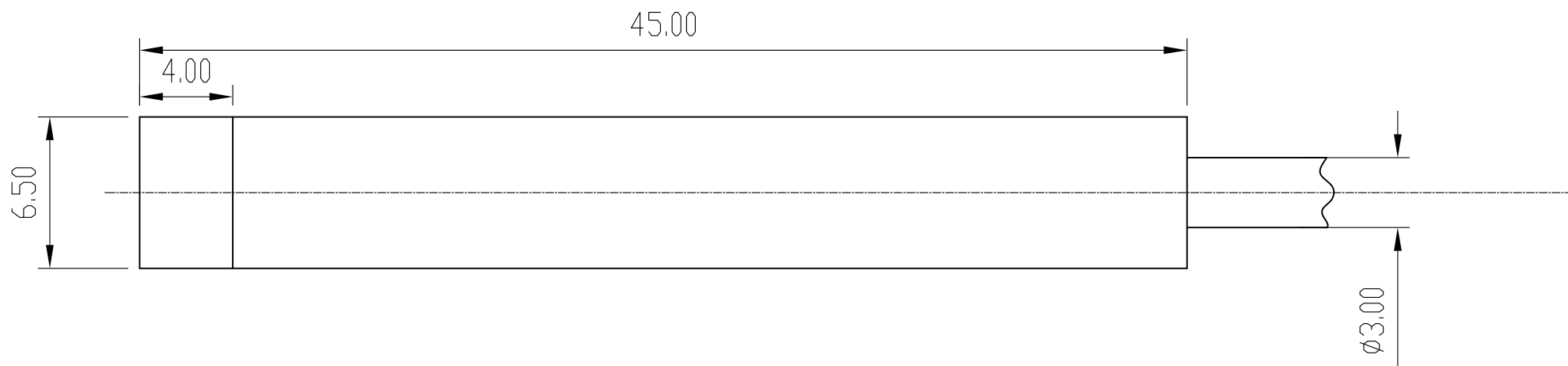

NOTES :

- | | |
|---|--|
| 1.0. Spec. ϕ 6.50mm | 11.0 Frequency: 2K HZ |
| 2.0. Metal cover housing: no, housing is longer | 12.0 Response Time: 0.1ms / 0.1ms |
| 3.0. Sensor distance: 2.00mm | 13.0 Power On/Off delay: 15% (Sr) max |
| 4.0. Shell Material: Stainless steel | 14.0 Repeat accuracy: 1.0 (Sr) max |
| 5.0. Operation Voltage: 5~36V DC | 15.0 Waterproof grade: IP67 |
| 6.0. Pulse Voltage: 10% max | 16.0 Temperature Range: $-25^{\circ}\text{C} \sim +70^{\circ}\text{C}$ |
| 7.0. Unload Current: 10mA max | 17.0 Temperature change: 10% (Sr) Max |
| 8.0. Load Current: 200mA | 18.0 Short protection: YES |
| 9.0. Leakage current: 0.01mA max | 19.0 Overload current: 220mA |
| 10.0 Voltage drop: 2.0V max | 20.0 Contact surface material: POM |

CMSNS6X1004

- 1: DC3 CABLE 10~30V NPN NORMAL OPEN
- 2: DC3 CABLE 10~30V NPN NORMAL CLOSE
- 3: DC3 CABLE 10~30V PNP NORMAL OPEN
- 4: DC3 CABLE 10~30V PNP NORMAL CLOSE

For more information, please feel free to contact Neal. His email is :connmold@foxmail.com Tel:18922965797

WWW.connmold.COM		ConnMold	
DIMENSION UNITS	TOLERANCE		
MM	X \pm 0.50 .XX \pm 0.25 .X \pm 0.35 .XXX \pm 0.15	PART NAME ϕ 6.50mm INDUCTANCE SENSOR DC SMALL SENSOR 2.00mm	
DRWN:Robert	Mar. 12, 2018	PART NUMBER	REVISION
CHK'D:Yuri	Mar. 12, 2018	CMSNS6X1004	A
APPR:Lee	Mar. 12, 2018	CUSTOMER	SHEET NUMBER
THIRD ANGLE PROJECTION	CUSTOMER P/N	GENERAL MARKET	1 OF 1
	/		

6

5

4

3

2

1