

6

5

4

3

2

1

REV	EC No.	DESCRIPTION	Symbol	DATE
A	/	new release	/	Mar. 12, 2018

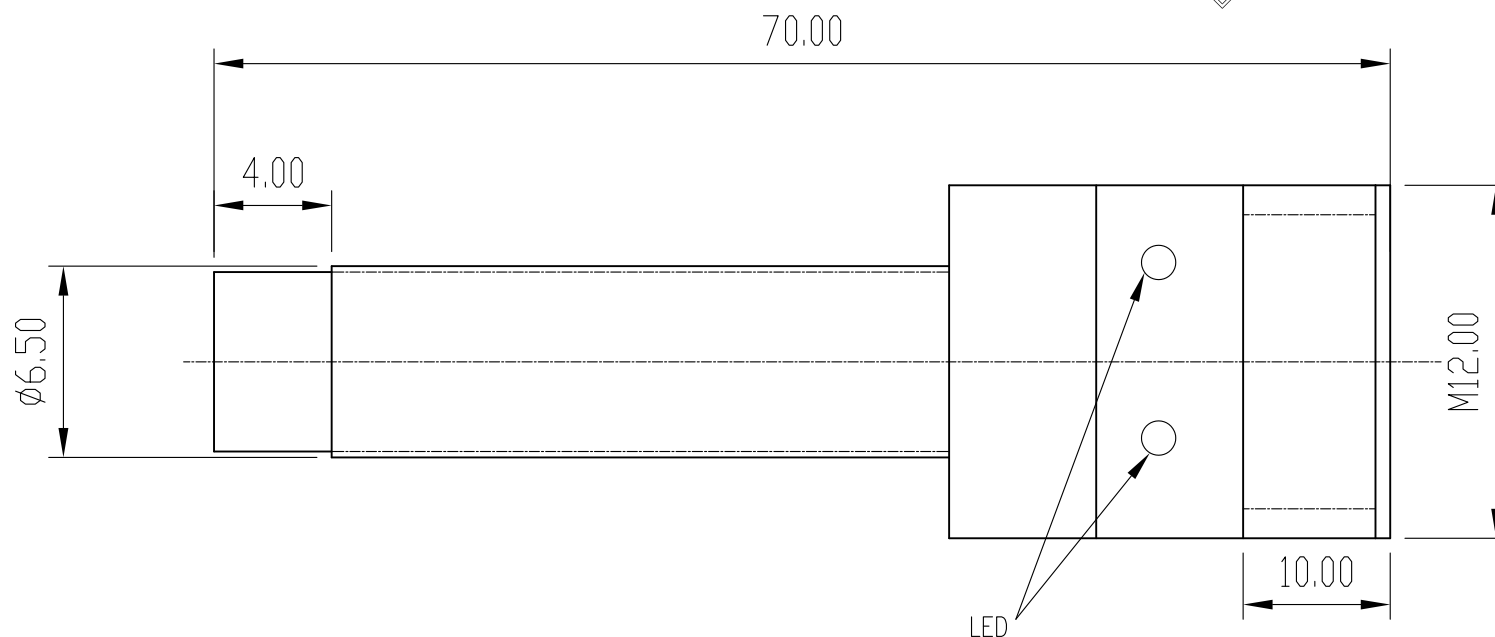

LED

CMSNS6X1012

NOTES :

- | | |
|--|---------------------------------------|
| 1.0. Spec.Ø6.50mm | 11.0 Frequency: 1000 HZ |
| 2.0. Metal cover housing: YES, Totally | 12.0 Response Time:0.2ms |
| 3.0. Sensor distance: 4.00mm | 13.0 Power On/Off delay: 15% (Sr) max |
| 4.0. Shell Material:Stainless steel | 14.0 Repeat accuracy: 1.0% (Sr) max |
| 5.0. Rated Voltage:10~30V DC | 15.0 Waterproof grade: IP67 |
| 6.0. Pulse Voltage: 10% max | 16.0 Temperature Range: -25°C~+70°C |
| 7.0. Unload Current: 10mA max | 17.0 Temperature change: 10% (Sr) Max |
| 8.0. Load Current: 200mA | 18.0 Short protection: YES |
| 9.0. Leakage current:0.01mA max | 19.0 Overload current: 220mA |
| 10.0 Voltage drop: 1.5V max | 20.0 Contact surface material:POM |

- 1: DC3 CABLE 10~30V NPN NORMAL OPEN
- 2: DC3 CABLE 10~30V NPN NORMAL CLOSE
- 3: DC3 CABLE 10~30V PNP NORMAL OPEN
- 4: DC3 CABLE 10~30V PNP NORMAL CLOSE

For more information, please feel free to contact Neal. His email is :connmold@foxmail.com Tel:18922965797

WWW.connmold.COM		ConnMold	
DIMENSION UNITS	TOLERANCE		
MM	X±0.50 .XX±0.25	PART NAME Ø6.50mm INDUCTANCE SENSOR DC THIN MINI SMALL SENSOR	
	.X±0.35 .XXX±0.15		
DRWN:Robert Mar. 12, 2018		PART NUMBER	
CHK'D:Yuri Mar. 12, 2018		CMSNS6X1002	
APPR:Lee Mar. 12, 2018		REVISION	
THIRD ANGLE PROJECTION		CUSTOMER	
CUSTOMER P/N		GENERAL MARKET	
/		SHEET NUMBER	
		1 OF 1	

6

5

4

3

2

1