

REV	EC No.	DESCRIPTION	Symbol	DATE
A	/	new release	/	Oct. 10, 2019

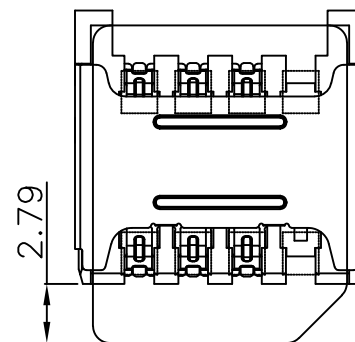

INSERT CARD

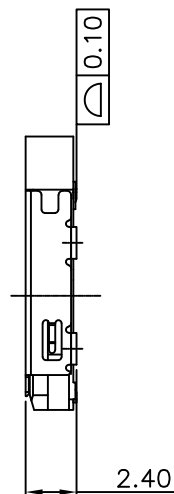
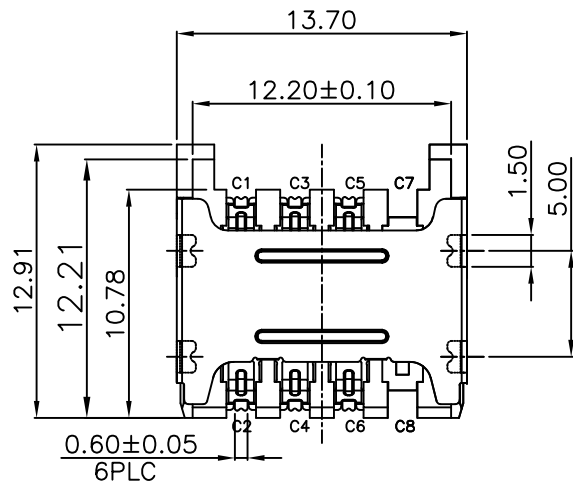
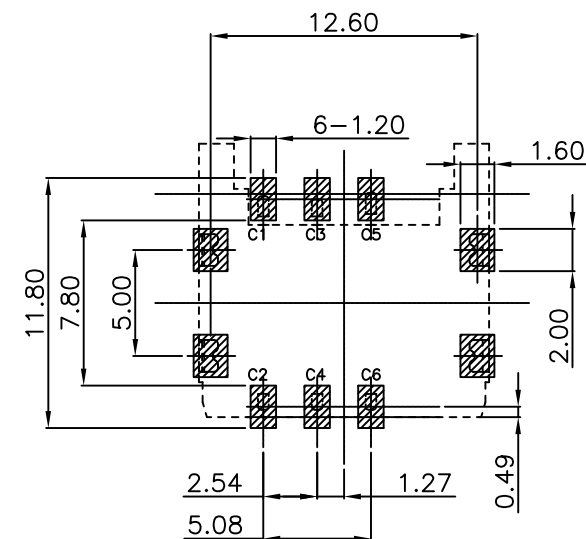

PATTERN PROHIBITION AREA
 PAD AREA
RECOMMENDED PCB LAYOUT(TOP VIEW)
 GENERAL TOLERANCES:±0.05

- SPECIFICATION:**
- MATERIAL:**
 - HOUSING:THERMOPLASTICS, LCP UL94V-0
 - TERMINAL:COPPER ALLOY
 - SHELL:STAINLESS STEEL
 - PLATED
 - TERMINAL:G/F PLATED ON CONTACT AREA**
Au ON SOLDER AREA
 - SHELL:NICKEL PLATED OVERALL**
 - ELECTRICAL CHARACTERISTICS:**
 - CURRENT RATING:DC 0.5A max.
 - VOLTAGE RATING:DC 30V.
 - CONTACT RESISTANCE: 50mΩ max
 - INSULATION RESISTANCE:1000MΩ min.
at 500V DC.
 - WITHSTANDING VOLTAGE:500V AC
for 1 minute.
 - OPERATION TEMPERATURE:-40°C~+85°C**
 - DURABILITY :5000 CYCLES**
 - PACKAGE: TAPE REEL,1000PCS/REEL,**

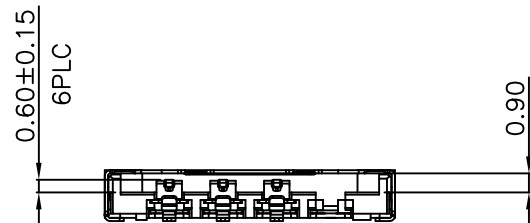

MICRO SIM CARD	
PIN NO.	DESCRIPTION
C1	VCC
C3	RST
C5	CLK
C7	
C2	GND
C4	VPP
C6	I/O
C8	

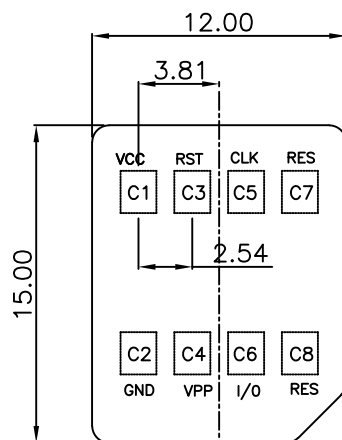

MICRO SIM CARD

For more information, please help to contact: connmold@foxmail.com Tel.:18922965797

WWW.connmold.COM		<h1>ConnMold</h1>	
DIMENSION UNITS	TOLERANCE		
MM	X±0.50 .XX±0.25 .X±0.35 .XXX±0.15	PART NAME	MICRO SIM PUSH PULL 2.40MM HEIGHT
DRWN:Robert	Oct.10,2019	PART NUMBER	CMMSM661008
CHK'D:Yuri	Oct.10,2019	REVISION	A
APPR:Linda	Oct.10,2019	CUSTOMER	GENERAL MARKET
THIRD ANGLE PROJECTION	CUSTOMER P/N	SHEET NUMBER	1 OF 2
	/		